

RISE SuperNodeSM

Research and Innovations to Support Empowerment (RISE) SuperNodeSM

The Enterprise and Empowerment Foundation of Norfolk State University*

Private synchronous fiber optic network provides ultra-high bandwidth interconnectivity to Hampton Roads and beyond.

An integral part of the **RISE CampusTM**, the **RISE SuperNodeSM** provides premier regional access to all major Points-of-Presence (gigaPOPs). The **RISE SuperNodeSM** is a private synchronous optical network (SONET) with ultra-high capacity, fault-tolerant design, offering speeds from 1.5 megabits per second (DS-1) up through multiple 10 Gbps (10,000 megabits per second) Lightwave networks. Powered by **Level 3 Communications'** premium fiber optic network, the **RISE SuperNodeSM** was designed with maximum availability in mind with features such as 24/7 monitoring, reliable backup power, and redundant connectivity in case of natural disaster or other emergencies. The **RISE SuperNodeSM** is wholly contained within a hardened, secured environment, and our services are backed by service level agreements (SLA) that meet or exceed present industry standards.

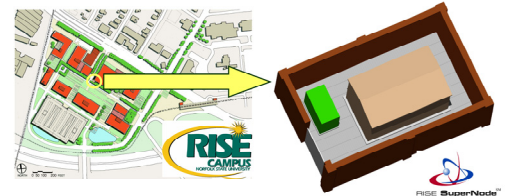

By way of **E²F Broadband, LLC**, the **RISE SuperNodeSM** currently provides premier, secure, and affordable broadband connectivity, co-location and Internet services to Norfolk State University and **ECPI College of Technology**. **E²F Broadband, LLC** will offer the same services to businesses and agencies that locate on the **RISE CampusTM** as well as those external to the **RISE CampusTM** to include local government, federal and state agencies, and institutions of higher learning.

In addition to providing real benefits today, the **RISE SuperNodeSM** is rapidly blazing a path to the future. For instance, clients will benefit from the future implementation of enterprise managed services (secure and reliable backup and storage services, web hosting, etc) as a component of the **E²F** business space. Also, our business partners and clients can use the **RISE SuperNodeSM** to provide high-speed, high-reliability interconnectivity between all of their offices, regionally and globally. By co-locating their businesses on the **RISE CampusTM**, tenants can enjoy the benefits of collaborative research with university faculty and industry researchers supported by students and scalable broadband infrastructure.



Due to the **RISE Campus**[™] location in an Empowerment Zone, Enterprise Community, HUBZone, and Hope VI community, businesses that reside on this campus can also enjoy the Federal and State New Market Tax credit benefits.

The **RISE SuperNode**SM offers reliable, high bandwidth connectivity options for institutions of higher learning and federal research labs. For example, it can link Historically Black Colleges and Universities (HBCUs) and other Minority Serving Institutions (MSIs) together for collaborative high-end research and academic instruction. The **RISE SuperNode**SM can support these institutions' connectivity needs to terascale-bandwidth research networks such as the National LambdaRail (NLR) and Internet2 while also providing broadband access for businesses.

At **E²F**, we consider the **RISE SuperNode**SM to be a vital component for your company's success in the technology-led economy of today and tomorrow. **E²F**, via its subsidiary **E²F Broadband, LLC**, is your link to the **RISE SuperNode**SM and we welcome the opportunity to help you realize all of the benefits described above.

For more information on the **RISE SuperNode**SM, including pricing and availability, please contact:

Mr. Shelley Thomas
Business Manager, Enterprise and Empowerment
Foundation of Norfolk State University
The Marie V. McDemmond Center for Applied Research,
Suite 601
Norfolk, Virginia 23504-4324
(757) 823-8265
smthomas@e2f-nsu.com or risesupernode@e2f-nsu.com

Dr. Adebisi Oladipupo
Executive Director, Enterprise and Empowerment
Foundation of Norfolk State University
The Marie V. McDemmond Center for Applied
Research, Suite 601
Norfolk, Virginia 23504-4324
(757) 823-8258
aoladipupo@e2f-nsu.com

* The mission of the **Enterprise and Empowerment Foundation of Norfolk State University** is to provide brands and services that promote applied research and technological innovations that, in turn, contribute positively to the economic strength of the Hampton Roads region and the Commonwealth of Virginia. The Foundation is the organizational power behind **E²F Real Estate**[™], **E²F Research**[™], the **Marie V. McDemmond Center for Applied Research**, the **RISE Campus**[™], and the **RISE SuperNode**SM.

The Enterprise and Empowerment Foundation name and logo, the E²F moniker, the E²F Real Estate name and logo, the E²F Research name and logo, the RISE Campus name and logo are registered trademarks of the Enterprise and Empowerment Foundation of Norfolk State University, and the RISE SuperNode name and logo is a registered service mark of the Enterprise and Empowerment Foundation of Norfolk State University. This material may not be republished, rewritten, reproduced, or redistributed without the prior written permission of E²F.

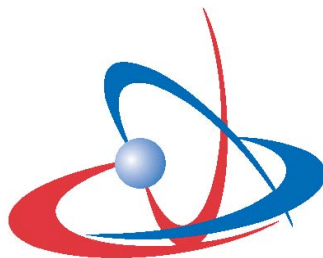

RISE SuperNodeSM